

**Bauwerk 01 ASB-Nr: 5820-690**  
 Omega Brücke im Zuge der K904  
 über die Strecke 3677 neu (RIG)

Bau-km 0+493.444 - Achse K 904  
 Kr Wi = variabel LW = 109.70 m  
 Stw. 25.07m-30.59m-25.73m-28.00m  
 LW und Stw. in Straßenachse K904  
 BzG = 14,50 m LH ≥ 6,20 m

**Bauwerk 01.1 Stützwand Nord**  
 ASB-Nr: 5820-690  
 Bau-km 0+394.000 bis 0+420.000  
 L = 25,00 m H = 0 bis 160m

**Bauwerk 01.2 Stützwand Süd**  
 ASB-Nr: 5820-690  
 Bau-km 0+410.000 bis 0+420.000  
 L = 10,00 m H = 0 bis 160m

H = -750.000 m  
 T = 45.000 m  
 f = -1350 m  
 km 0-500.000  
 h TS = 135.441 m

Achse 501 - Kreisstraße 904

Kleintierdurchlass 1  
 Bau-km 0+595.000  
 LW/LH = 175 m  
 Länge = 3100 m

Kleintierdurchlass 2  
 Bau-km 0+650.000  
 LW/LH = 175 m  
 Länge = 2200 m

H = 1525.000 m  
 T = 36.783 m  
 f = 0.444 m  
 km 0+652.912  
 h TS = 126.266 m

H = 6480.000 m  
 T = 18.648 m  
 f = 0.027 m  
 km 0+801.055  
 h TS = 124.524 m

ohne Ausrundung  
 km 0+875.000  
 h TS = 124.080 m

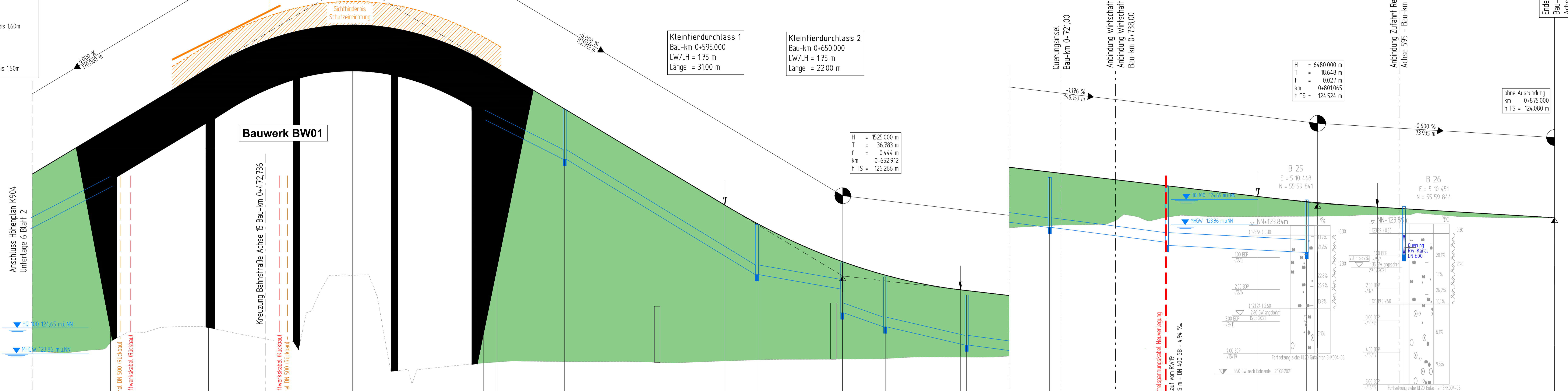

Station	0+400	0+410	0+420	0+430	0+440	0+450	0+460	0+470	0+480	0+490	0+500	0+510	0+520	0+530	0+540	0+550	0+560	0+570	0+580	0+590	0+600	0+610	0+620	0+630	0+640	0+650	0+660	0+670	0+680	0+690	0+700	0+710	0+720	0+730	0+740	0+750	0+760	0+770	0+780	0+790	0+800	0+810	0+820	0+830	0+840	0+850	0+860	0+870	0+880	0+890	0+900																																																																																																																																																																																																																																																																																																																																																																																																																																																																																																																																																																																																																																																																																																																																																																																																																																																											
Gradientenhöhe	1294.4	1300.6	1301.1	1301.3	1301.4	1301.5	1301.6	1301.7	1301.8	1301.9	1302.0	1302.1	1302.2	1302.3	1302.4	1302.5	1302.6	1302.7	1302.8	1302.9	1303.0	1303.1	1303.2	1303.3	1303.4	1303.5	1303.6	1303.7	1303.8	1303.9	1304.0	1304.1	1304.2	1304.3	1304.4	1304.5	1304.6	1304.7	1304.8	1304.9	1305.0	1305.1	1305.2	1305.3	1305.4	1305.5	1305.6	1305.7	1305.8	1305.9	1306.0	1306.1	1306.2	1306.3	1306.4	1306.5	1306.6	1306.7	1306.8	1306.9	1307.0	1307.1	1307.2	1307.3	1307.4	1307.5	1307.6	1307.7	1307.8	1307.9	1308.0	1308.1	1308.2	1308.3	1308.4	1308.5	1308.6	1308.7	1308.8	1308.9	1309.0	1309.1	1309.2	1309.3	1309.4	1309.5	1309.6	1309.7	1309.8	1309.9	1310.0	1310.1	1310.2	1310.3	1310.4	1310.5	1310.6	1310.7	1310.8	1310.9	1311.0	1311.1	1311.2	1311.3	1311.4	1311.5	1311.6	1311.7	1311.8	1311.9	1312.0	1312.1	1312.2	1312.3	1312.4	1312.5	1312.6	1312.7	1312.8	1312.9	1313.0	1313.1	1313.2	1313.3	1313.4	1313.5	1313.6	1313.7	1313.8	1313.9	1314.0	1314.1	1314.2	1314.3	1314.4	1314.5	1314.6	1314.7	1314.8	1314.9	1315.0	1315.1	1315.2	1315.3	1315.4	1315.5	1315.6	1315.7	1315.8	1315.9	1316.0	1316.1	1316.2	1316.3	1316.4	1316.5	1316.6	1316.7	1316.8	1316.9	1317.0	1317.1	1317.2	1317.3	1317.4	1317.5	1317.6	1317.7	1317.8	1317.9	1318.0	1318.1	1318.2	1318.3	1318.4	1318.5	1318.6	1318.7	1318.8	1318.9	1319.0	1319.1	1319.2	1319.3	1319.4	1319.5	1319.6	1319.7	1319.8	1319.9	1320.0	1320.1	1320.2	1320.3	1320.4	1320.5	1320.6	1320.7	1320.8	1320.9	1321.0	1321.1	1321.2	1321.3	1321.4	1321.5	1321.6	1321.7	1321.8	1321.9	1322.0	1322.1	1322.2	1322.3	1322.4	1322.5	1322.6	1322.7	1322.8	1322.9	1323.0	1323.1	1323.2	1323.3	1323.4	1323.5	1323.6	1323.7	1323.8	1323.9	1324.0	1324.1	1324.2	1324.3	1324.4	1324.5	1324.6	1324.7	1324.8	1324.9	1325.0	1325.1	1325.2	1325.3	1325.4	1325.5	1325.6	1325.7	1325.8	1325.9	1326.0	1326.1	1326.2	1326.3	1326.4	1326.5	1326.6	1326.7	1326.8	1326.9	1327.0	1327.1	1327.2	1327.3	1327.4	1327.5	1327.6	1327.7	1327.8	1327.9	1328.0	1328.1	1328.2	1328.3	1328.4	1328.5	1328.6	1328.7	1328.8	1328.9	1329.0	1329.1	1329.2	1329.3	1329.4	1329.5	1329.6	1329.7	1329.8	1329.9	1330.0	1330.1	1330.2	1330.3	1330.4	1330.5	1330.6	1330.7	1330.8	1330.9	1331.0	1331.1	1331.2	1331.3	1331.4	1331.5	1331.6	1331.7	1331.8	1331.9	1332.0	1332.1	1332.2	1332.3	1332.4	1332.5	1332.6	1332.7	1332.8	1332.9	1333.0	1333.1	1333.2	1333.3	1333.4	1333.5	1333.6	1333.7	1333.8	1333.9	1334.0	1334.1	1334.2	1334.3	1334.4	1334.5	1334.6	1334.7	1334.8	1334.9	1335.0	1335.1	1335.2	1335.3	1335.4	1335.5	1335.6	1335.7	1335.8	1335.9	1336.0	1336.1	1336.2	1336.3	1336.4	1336.5	1336.6	1336.7	1336.8	1336.9	1337.0	1337.1	1337.2	1337.3	1337.4	1337.5	1337.6	1337.7	1337.8	1337.9	1338.0	1338.1	1338.2	1338.3	1338.4	1338.5	1338.6	1338.7	1338.8	1338.9	1339.0	1339.1	1339.2	1339.3	1339.4	1339.5	1339.6	1339.7	1339.8	1339.9	1340.0	1340.1	1340.2	1340.3	1340.4	1340.5	1340.6	1340.7	1340.8	1340.9	1341.0	1341.1	1341.2	1341.3	1341.4	1341.5	1341.6	1341.7	1341.8	1341.9	1342.0	1342.1	1342.2	1342.3	1342.4	1342.5	1342.6	1342.7	1342.8	1342.9	1343.0	1343.1	1343.2	1343.3	1343.4	1343.5	1343.6	1343.7	1343.8	1343.9	1344.0	1344.1	1344.2	1344.3	1344.4	1344.5	1344.6	1344.7	1344.8	1344.9	1345.0	1345.1	1345.2	1345.3	1345.4	1345.5	1345.6	1345.7	1345.8	1345.9	1346.0	1346.1	1346.2	1346.3	1346.4	1346.5	1346.6	1346.7	1346.8	1346.9	1347.0	1347.1	1347.2	1347.3	1347.4	1347.5	1347.6	1347.7	1347.8	1347.9	1348.0	1348.1	1348.2	1348.3	1348.4	1348.5	1348.6	1348.7	1348.8	1348.9	1349.0	1349.1	1349.2	1349.3	1349.4	1349.5	1349.6	1349.7	1349.8	1349.9	1350.0	1350.1	1350.2	1350.3	1350.4	1350.5	1350.6	1350.7	1350.8	1350.9	1351.0	1351.1	1351.2	1351.3	1351.4	1351.5	1351.6	1351.7	1351.8	1351.9	1352.0	1352.1	1352.2	1352.3	1352.4	1352.5	1352.6	1352.7	1352.8	1352.9	1353.0	1353.1	1353.2	1353.3	1353.4	1353.5	1353.6	1353.7	1353.8	1353.9	1354.0	1354.1	1354.2	1354.3	1354.4	1354.5	1354.6	1354.7	1354.8	1354.9	1355.0	1355.1	1355.2	1355.3	1355.4	1355.5	1355.6	1355.7	1355.8	1355.9	1356.0	1356.1	1356.2	1356.3	1356.4	1356.5	1356.6	1356.7	1356.8	1356.9	1357.0	1357.1	1357.2	1357.3	1357.4	1357.5	1357.6	1357.7	1357.8	1357.9	1358.0	1358.1	1358.2	1358.3	1358.4	1358.5	1358.6	1358.7	1358.8	1358.9	1359.0	1359.1	1359.2	1359.3	1359.4	1359.5	1359.6	1359.7	1359.8	1359.9	1360.0	1360.1	1360.2	1360.3	1360.4	1360.5	1360.6	1360.7	1360.8	1360.9	1361.0	1361.1	1361.2	1361.3	1361.4	1361.5	1361.6	1361.7	1361.8	1361.9	1362.0	1362.1	1362.2	1362.3	1362.4	1362.5	1362.6	1362.7	1362.8	1362.9	1363.0	1363.1	1363.2	1363.3	1363.4	1363.5	1363.6	1363.7	1363.8	1363.9	1364.0	1364.1	1364.2	1364.3	1364.4	1364.5	1364.6	1364.7	1364.8	1364.9	1365.0	1365.1	1365.2	1365.3	1365.4	1365.5	1365.6	1365.7	1365.8	1365.9	1366.0	1366.1	1366.2	1366.3	1366.4	1366.5	1366.6	1366.7	1366.8	1366.9	1367.0	1367.1	1367.2	1367.3	1367.4	1367.5	1367.6	1367.7	1367.8	1367.9	1368.0	1368.1	1368.2	1368.3	1368.4	1368.5	1368.6	1368.7	1368.8	1368.9	1369.0	1369.1	1369.2	1369.3	1369.4	1369.5	1369.6	1369.7	1369.8	1369.9	1370.0	1370.1	1370.2	1370.3	1370.4	1370.5	1370.6	1370.7	1370.8	1370.9	1371.0	1371.1	1371.2	1371.3	1371.4	1371.5	1371.6	1371.7	1371.8	1371.9	1372.0	1372.1	1372.2	1372.3	1372.4	1372.5	1372.6	1372.7	1372.8	1372.9	1373.0	1373.1	1373.2	1373.3	1373.4	1373.5	1373.6	1373.7	1373.8	1373.9	1374.0	1374.1	1374.2	1374.3	1374.4	1374.5	1374.6	1374.7	1374.8	1374.9	1375.0	1375.1	1375.2	1375.3	1375.4	1375.5	1375.6	1375.7	1375.8	1375.9	1376.0	1376.1	1376.2	1376.3	1376.4	1376.5	1376.6	1376.7	1376.8	1376.9	1377.0	1377.1	1377.2	1377.3	1377.4	1377.5	1377.6	1377.7	1377.8	1377.9	1378.0	1378.1	1378.2	1378.3	1378.4	1378.5	1378.6	1378.7	1378.8	1378.9	1379.0	1379.1	1379.2	1379.3	1379.4	1379.5	1379.6	1379.7	1379.8	1379.9	1380.0	1380.1	1380.2	1380.3	1380.4	1380.5	1380.6	1380.7	1380.8	1380.9	1381.0	1381.1	1381.2	1381.3	1381.4	1381.5	1381.6	1381.7	1381.8	1381.9	1382.0	1382.1	1382.2	1382.3	1382.4	1382.5	1382.6	1382.7	1382.8	1382.9	1383.0	1383.1	1383.2	1383.3	1383.4	1383.5	1383.6	1383.7	1383.8	1383.9	1384.0	1384.1	1384.2	1384.3	1384.4	1384.5	1384.6	1384.7	1384.8	1384.9	1385.0	1385.1	1385.2	1385.3	1385.4	1385.5	1385.6	1385.7	1385.8	1385.9	1386.0	1386.1	1386.2	1386.3	1386.4	1386.5	1386.6	1386.7	1386.8	1386.9	1387.0	1387.1	1387.2	1387.3	1387.4	1387.5	1387.6	1387.7	1387.8	1387.9	1388.0	1388.1	1388.2	1388.3	1388.4	1388.5	1388.6	1388.7</